

8MP FIXED VANDAL DOME CAMERA



ENV-HCVAF-30R-91

FEATURES

2.8 mm Fixed Lens
Smart IR Up to 30 m
ONVIF Profile (S, G, T, M)
Triple Stream
Built-in Mic
PoE, IP67, IK10

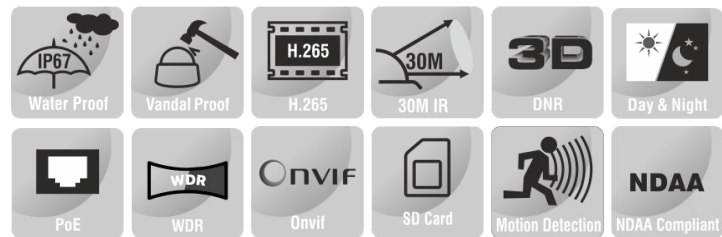

SPECIFICATION

MODEL	Model No.	ENV-HCVAF-30R-91
	Type	8MP FIXED VANDAL DOME CAMERA
CAMERA	Image Sensor	1/2.8" CMOS Progressive 8.0 MegaPixel
	Day/Night	Dual IR Cut Filter with Auto Switch
	Lens Type	Fixed
	Focal Length	2.8 mm
	Digital Zoom	16x
	Iris	Fixed
	Lens Mount	M12
	Angle of View (H)	100.5°
	Angle of View (V)	56.5°
	Angle of View (D)	113.0°
	Angle Adjustment	Pan 0~330°, Tilt 0~75°, Rotate 0~350°
	Aperture	F1.6
	Electronic Shutter	1s ~ 1/100,000s, Auto / Manual
	Min. Illumination	Color: 0.001 lux @ F1.6, B/W: 0 lux with IR
	AGC	Auto / Manual
	Digital Noise Reduction	3D DNR
	S/N Ratio	≥60 dB
Defog	Smart Defog	
WDR	120 dB	
Smart IR	Up to 30 m	
IR LEDs	8	
Warm Light	Up to 10 m	
Warm Light LEDs	8	
Wavelength	850 nm	

★Product specification and availability are subject to change without notice.

8MP FIXED VANDAL DOME CAMERA



ENV-HCVAF-30R-91

MODEL	Model No.	ENV-HCVAF-30R-91
	Type	8MP FIXED VANDAL DOME CAMERA
DORI	Lens	2.8 mm
	Detection	77.0 m
	Observation	30.5 m
	Recognition	15.5 m
	Identification	7.5 m
VIDEO	Max. Resolution	3840x2160
	Video Compression	Enhanced (H.265, H.264), H.265, H.264, MJPEG
	Frame Rate	Main Stream: (3840x2160, 3072x2048) @ 20fps, (2560x1440, 2304x1296, 1920x1080, 1280x720) @ 25/30fps Sub Stream: (704x480, 704x240, 352x240, 640x360) @ 30fps, (704x576, 704x288, 352x288, 640x360) @ 25fps Third Stream: (704x480, 704x240, 352x240, 640x480) @ 30fps, (704x576, 704x288, 352x288, 640x360) @ 25fps
	Stream Settings	i-Frame, PAL/NTSC, Frame Rate
	Video Bit Rate	32 kbps ~ 16 Mbps
	Bitrate Type	CBR, VBR
	Image Settings	Brightness, Contrast, Saturation, Hue, Sharpness, Rotation/Mirror, Gain, Exposure, Day/Night
	White Balance	Auto, Semi Auto, Sunshine, Daylight, Warm Light, Filament, Nature Light, Lock WB, Manual
	Corridor Mode	Supported
	HLC	Supported
	BLC	Supported
	OSD	Up to 5 regions
	OSD Type	Title, Week, Date, Time, Text with different colors and adaptable sizes (16x16, 32x32, 48x48, 64x64, 96x96), Image Overlay
	ROI	Up to 8 regions
	Privacy Mask	Up to 4 regions
	AUDIO	Audio Compression
Audio Bit Rate		8 kbps, 32 kbps, 48 kbps
Audio I/O		N/A
Audio Voltage		N/A
Built-in Mic		Supported with noise cancellation
SMART	Behavior Detection	Intrusion (Perimeter), Crossline (Tripwire)
	Intelligent Identification	N/A
	Statistical Analysis	Human & Vehicle Classification
	Alarm Management	Motion Detection, Tampering (Masking), Input & Output Event, IP & MAC Address Conflict, Disk Alarm (Full & R/W Error), FTP Server Exception, Abnormal Voltage, Pre/Post Alarm Recording, Alarm Recording/Snapshot
	Alarm Notification	E-mail (Notification and Snapshot), HTTP (Alarm Icon), FTP (Snapshot and Recording), SD Card (Recording)
INTERFACE	Protocols	TCP/IP, UDP, IPv4, IPv6, ICMP, HTTP, HTTPS, FTP, DHCP, DNS, DDNS, RTP, RTSP, RTCP, RTMP, PPPoE, NTP, UPnP, SMTP, SSL, TLS 1.2, IGMP, 802.1X, QoS, Unicast, Multicast, ARP, SNMP, SFTP, SRTP, P2P
	Security	AES 128 Video Encryption, IP Filter, User Authentication (Multiple Privilege Level)
	Compatibility	ONVIF Profile (S, G, T, M), SDK/API/CGI
	Network	1 x RJ45 10M/100M Self Adaptive Ethernet Port
	Alarm I/O	N/A
	Alarm Voltage	N/A
	Serial Interface	N/A
	Edge Storage	Micro SD Card Slot, Up to 512 GB
	ANR	Supported
	Built-in Speaker	N/A
	Cable Interface	Cable Free
	Remote Connection	≤2
	Max. Users	32
Web Language	15	
Client Application	EyeConnect	

★Product specification and availability are subject to change without notice.

8MP FIXED VANDAL DOME CAMERA



ENV-HCVAF-30R-91

MODEL		ENV-HCVAF-30R-91
Type		8MP FIXED VANDAL DOME CAMERA
GENERAL	Power Supply	12V DC, PoE (802.3af)
	Max. Power Consumption	≤6 W (12V DC), ≤7.5 W (PoE)
	Working Temperature	-40 °C ~ 65 °C
	Working Humidity	≤95% RH (non-condensing)
	Casing	Metal + Plastic
	Ingress Protection	IP67
	Vandal Resistant	IK10
	Surge Protection	TVS4000V
	Reset Button	Supported
	Dimensions	Φ120×90 mm
Net Weight	0.4 Kg	

Dimension Unit : mm

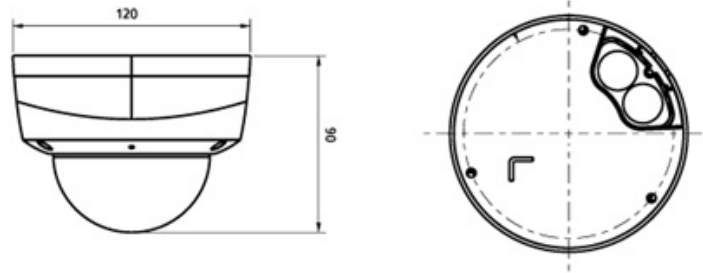

ORDERING INFORMATION

Part Number	Description	Standard Quantity
ENV-HCVAF-30R-91	8MP Low light IR IP H.265 Vandal Proof Compact Dome camera with 2.8mm Fixed Lens, PoE, WDR, SD card slot, Built-in Mic and 30m IR support	1
ENB-BTDV66	Pole Mount Bracket for Norden Dome Camera	1
ENB-BTDH66	Outer Corner Bracket for Norden Dome Camera	1
ENB-BTDW66	Wall Mount Bracket for Norden Fixed Lens Dome Camera (Metal)	1
ENB-BTEW65	Wall Mount for Norden Lite Series Mini Dome (Plastic)	1

PACKING INFORMATION

Part Number	Packing Mode	Gross weight(Kg)	Dimension(mm)
ENV-HCVAF-30R-91	Carton Box	0.6	140×140×120